

FORSTER TERASPROFIILID

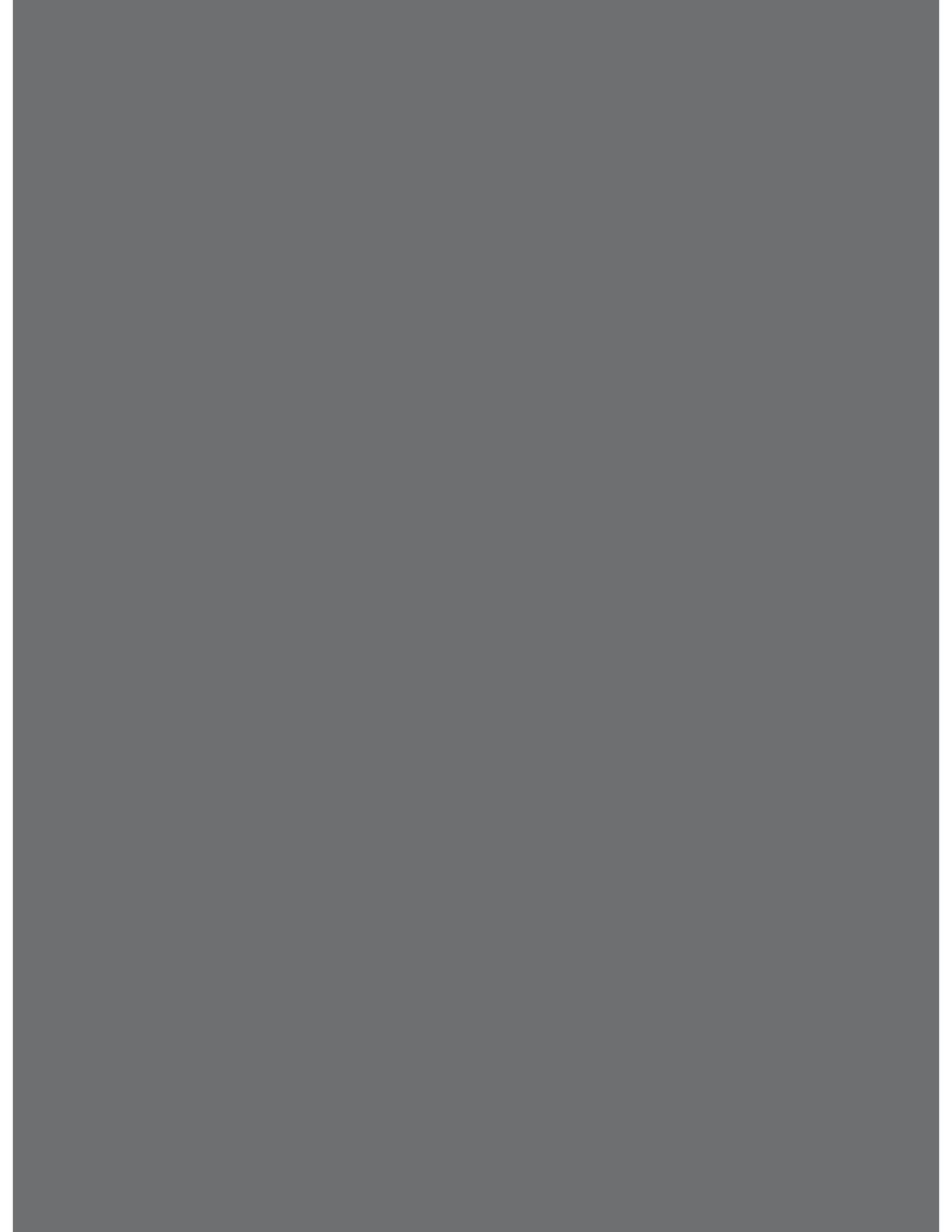

FORSTER TERASPROFIILTOOTED

TERASEMARK

DD11 (RSTW22) / S235JRG2 / X5CRNI18-10 2G

STANDARD

DIN EN 10111 / DIN EN 10025 / 1.4301 EN 10088-2

PIKKUS- JA NURGATOLERANTS

DIN ISO2768-1

Norm sari		Mõõdud	Kaal kg/m
01.220		34x15x15	1,850
01.230		34x20x15	2,000
01.260		34x30x15	2,300
01.290		34x35x15	2,450
01.315		34x50x15	2,950
01.320		34x55x15	3,100
01.415		40x20x20	2,350
01.485		40x40x20	2,900
01.487		40x50x20	3,300
01.492		40x70x20	3,900
01.535		50x20x20	2,680
01.565		50x40x20	3,300
01.570	50x50x20	3,600	
01.587	50x90x20	4,830	
01.635	60x20x20	3,000	
01.685	60x50x20	3,900	
02.220		34x15x15	2,300
02.230		34x20x15	2,460
02.260		34x30x15	2,750
02.290		34x35x15	2,910
02.315		34x50x15	3,400
02.415		40x20x20	2,970
02.485		40x40x20	3,600
02.487		40x50x20	3,920
02.535		50x20x20	3,300
02.565		50x40x20	3,920
02.570		50x50x20	4,220

FORSTER TERASPROFIILTOOTED

Norm sari		Mõõdud	Kaal kg/m
02.635		60x20x20	3,600
02.685		60x50x20	4,500
03.290		34x35x15	2,910
03.315		34x50x15	3,400
03.415		40x20x20	2,970
03.485		40x40x20	3,600
03.487		40x50x20	3,920
03.535		50x20x20	3,300
03.565		50x40x20	3,920
03.570		50x50x20	4,220
03.635		60x20x20	3,600
03.685		60x50x20	4,510
06.485		40x40x20	3,520
06.570		50x50x20	4,150
07.570		50x50x20	4,150
11.485		40x40x20	3,050
11.570		50x50x20	3,690
12.485		40x40x20	3,660
12.570		50x50x20	4,300
12.685		60x50x20	4,640
13.485		40x40x20	3,660
13.570		50x50x20	4,300
13.685		60x50x20	4,640
32.366		50x50x20	3,870

PRESTO TIHENDISOONEGA PROFIIID	Mõõdud	Kaal kg/m
32.800	50x50x20	2,850
32.801	50x50x20	2,850
32.803	50x50x20	3,300
32.804	50x50x20	3,450
32.805	50x50x20	3,300
32.806	50x50x20	2,900
32.807	50x25x20	2,810
32.808	50x25x20	2,810
32.810	50x40x20	2,773
32.818	50x25x20	2,402

FORSTER TERASPROFIILTOOTED

PRESTO TIHENDISOONEGA PROFIIID	Mõõdud	Kaal kg/m
32.851	50x50x20	2,700
32.852	50x50x20	3,160
32.853	50x50x20	3,160
32.855	50x50x20	3,620
35.800	60x50x20	4,192
35.803	60x50x20	4,866
35.805	60x50x20	4,866
PRESTO CrNi PROFIIID	Mõõdud	Kaal kg/m
01.545	50x20x20	1,983
02.545	50x20x20	2,450
32.800	50x50x20	2,850
32.803	50x50x20	3,300
32.805	50x50x20	3,300
32.851	50x50x20	2,700
32.852	50x50x20	3,160
UNICO KÜLMAKATKESTUSEGA PROFIIID must teras, ZN, CrNi	Mõõdud	Kaal kg/m
530.620	70x20	1,826
530.711	70x10x20	1,826
530.712	70x10x20	2,300
530.800	88x50x20	4,080
531.731	70x30x20	3,130
531.732	70x30x20	3,385
531.733	70x30x20	3,385
531.750	70x50	3,405
531.751	70x50x20	3,865
531.752	70x50x20	4,325
531.753	70x50x20	4,325
531.755	70x50x20	4,780
532.620	70x20	1,790
533.731	70x30x15	3,008
533.732	70x30x15/20	3,463
533.733	70x30x15/20	3,463
533.751	70x50x15	3,950
533.752	70x50x15/20	4,405
533.753	70x50x15/20	4,405

FORSTER TERASPROFIILTOOTED

FUEGO LIGHT TULEKINDLAD PROFILID	Mõõdud	Kaal kg/m
735.552	50x20x20	3,955
735.800	65x50x20	4,695
735.800T	65x50x20	4,559
735.803	65x50x20	5,142
735.803T	65x50x20	5,020
735.805	65x50x20	5,142
735.805T	65x50x20	5,016
735.831	65x30x20	3,189
735.832	65x30x20	3,650
735.850	65x50	4,071
735.851	65x50x20	4,516
735.852	65x50x20	4,977
735.853	60x50x20	4,961
735.855	65x50x20	5,422
736.800	65x50x20	6,240
736.803	65x50x20	6,695
736.803T	65x50x20	6,607
736.805	65x50x20	6,695
736.805T	65x50x20	6,607
736.830	65x30	3,800
736.831	65x30x20	4,260
736.832	65x30x20	4,715
736.850	65x50	5,904
736.851	65x50x20	6,246
736.852	65x50x20	6,702
736.853	65x50x20	6,706
KLAASILIISTUD, TSINGITUD	Mõõdud	Kaal kg/m
901226	15x20	0,541
901227	20x20	0,721
901228	25x20	0,732
901241	10x20	0,481
901245	2,5x20	0,336
901246	30x20	0,826
901247	35x20	0,919
901248	40x20	1,016
901249	45x20	1,113

FORSTER TERASPROFIILTOOTED

KLAASILIISTUD, CrNi	Mõõdud	Kaal kg/m
901526	15x20	0,550
601527	20x20	0,655
901528	25x20	0,745
901546	30x20	0,850
901547	35x20	0,925
901548	40x20	1,016
KLAASILIISTUD, ALUMIINIUM	Mõõdud	Kaal kg/m
901326	15x20	0,197
901327	20x20	0,225
901328	25x20	0,324
901335	30x20	0,415
901336	35x20	0,455
FORSTER KINNITUSTARVIKUD	Mõõdud	Nro
Kummitihend		905200
Kummitihend		905201
Kummitihend, Presto		905306
Kummitihend, Presto EI30, Fuego Light		905307
Kummitihend, Presto, Fuego Light	2 mm	905312
Kummitihend, Presto, Fuego Light	5 mm	905314
Kummitihend, Presto, Fuego Light	3-5 mm	905315
Kummitihend, Presto, Fuego Light	4-6 mm	905316
Kummitihend, Presto, Fuego Light	6-8 mm	905317
Haritihend		905900
Kummitihend, ovi, Unico		985301
Kattetihend, Unico		985304
Kattetihend, Unico		985305
Klaasitihend, välis, Unico	5 mm	985302
Klaasitihend, sise, Unico	5-6 mm	905385
Klaasitihend, sise, Unico	7-8 mm	905386
Klaasitihend, sise, Unico	9-10 mm	905387
Aknatihend, sise, Unico		985300
Aknatihend, keskmine, Unico		985303
Nurgadetail aknatihendile		985601
Tihendusdetail, vasak		985631
Tihendusdetail, parem		985632

FORSTER TERASPROFIILTOOTED

FORSTER KINNITUSTARVIKUD	Mõõdud	Nro
Kinnitusdetail		987701
Kinnitusdetail		987703
Paisuvtihend	24,5x1,5	948000
Paisuvtihend	24x2,2	948002
Paisuvtihend	15x3	948003
Paisuvtihend	15x4	948004
Paisuvtihend	15x5	948005
Paisuvtihend	15x6	948006
Paisuvtihend	29,5x2,2	948015
Vedru		906420
Kinnituskruvi		906577
Masinkinnituskruvi		906579
Kinnituskruvi, CrNi		906583

HINGED JA SULUSED	Mõõdud
Terashing	60 mm
Terashing	80 mm
Terashing	100 mm
Terashing	120 mm
Terashing	140 mm
Terashing määrdenipliga	140 mm
Terashing	180 mm
Roostevaba hing	120 mm
Roostevaba hing	140 mm
Angaariukse hing	240 mm
Angaariukse hing	260 mm
Tuletõkkeukse hing, tsingitud	175 mm
Uksesulus parem, tsingitud	165 mm/parem
Uksesulus vasak, tsingitud	165 mm/vasak
Uksesulus parem, tsingitud	260 mm/parem
Uksesulus vasak, tsingitud	260 mm/vasak
Kiirsulus alumiiniumkäepidemega	10-230/alu
Puurimismasin	909203
Puuriotsik	909205

FORSTER TERASPROFIILTOOTED

KÜLMAKATKESTUSEGA
THERMAL INSULATION

forsterthermfix® vario

Teras
Steel
Stahl

Roostevaba teras
Stainless steel
Edelstahl

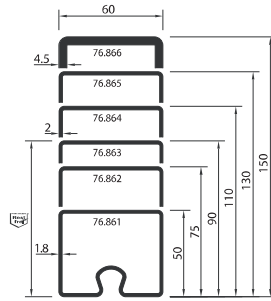
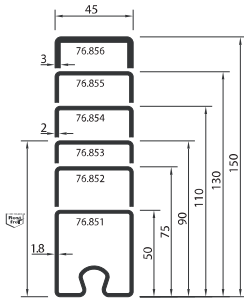

forsterthermfix® light

Teras
Steel
Stahl

Roostevaba teras
Stainless steel
Edelstahl

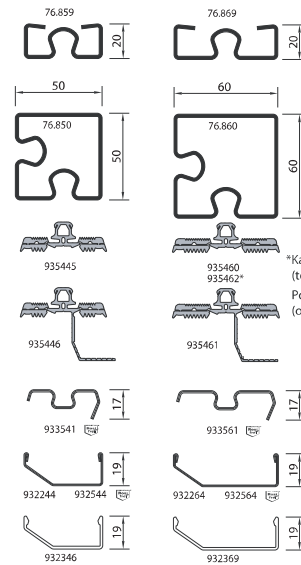
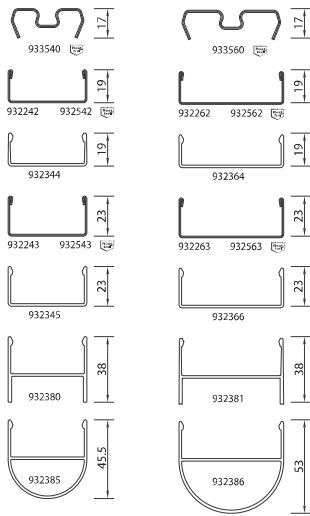
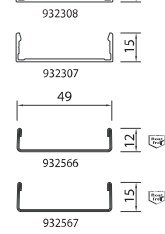
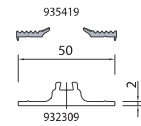
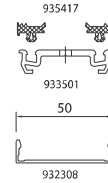
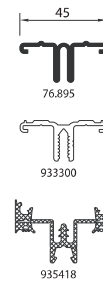

*Kaetud pinnaga
(tellimisel)
Polygonal glazing
(on request)

936869 - 936894

935000 - 935005

936830 / 936831

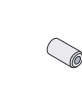
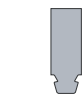

forsterthermfix® vario SV

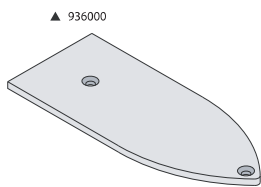

▲ tellimisel
on request

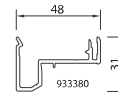
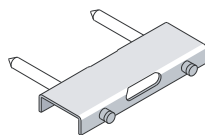
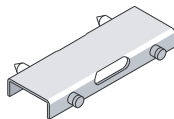
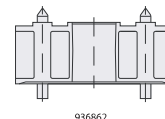
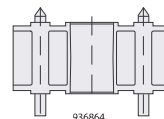
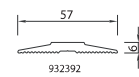
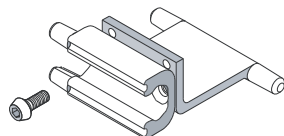
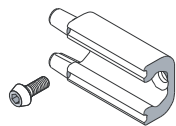
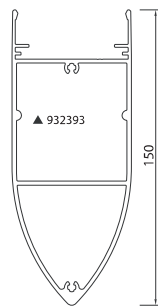

936570

936720 - 936731

936735 - 936743

936840 - 936861

908001

935201

908002



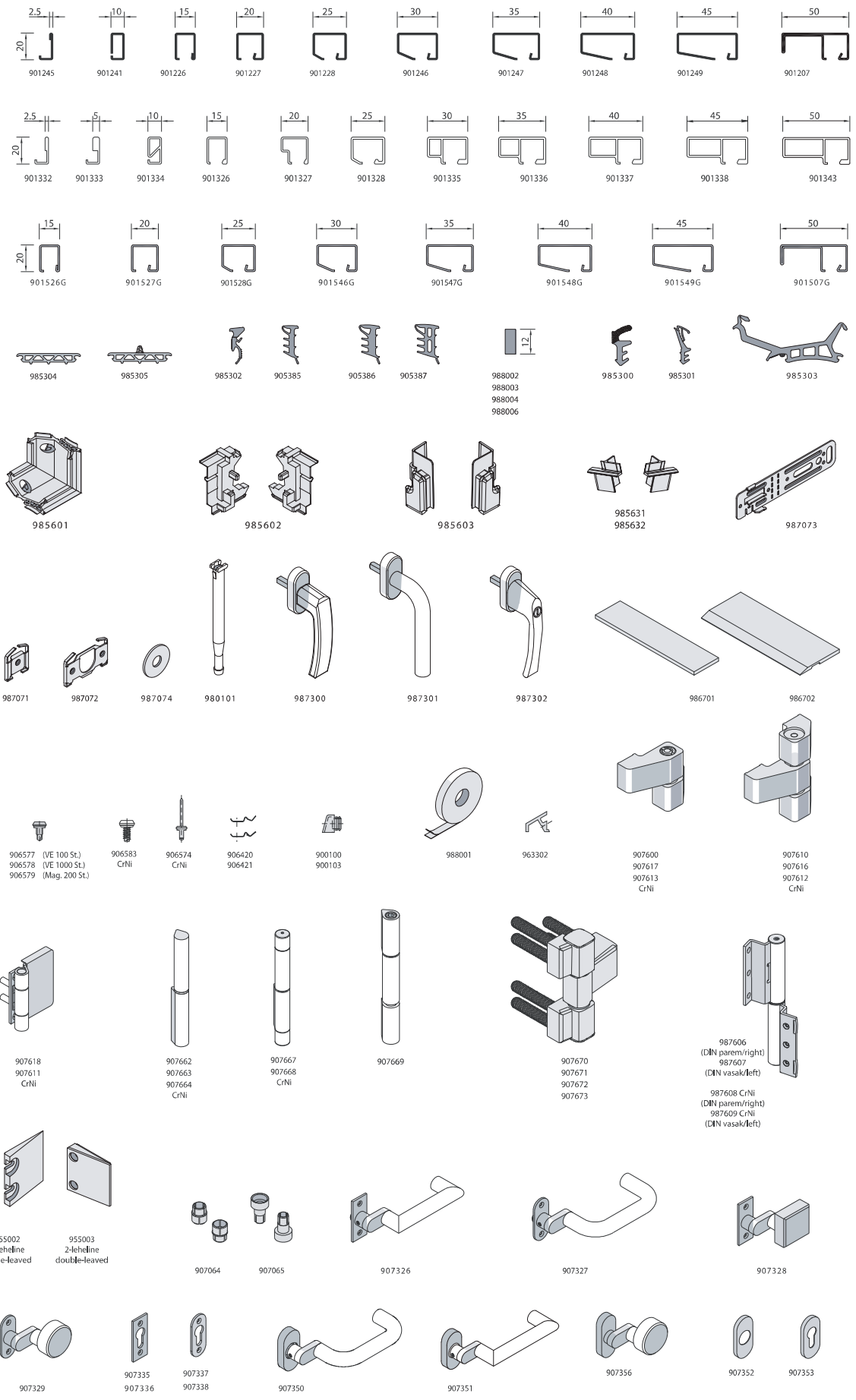

Teras
Steel
Stahl

Roostevaba teras
Stainless steel
Edelstahl

E30(R30), E130/E190

forster presto®

Teras
Steel
Stahl

50

E30/E60/E90/E120

forsterthermfix® vario

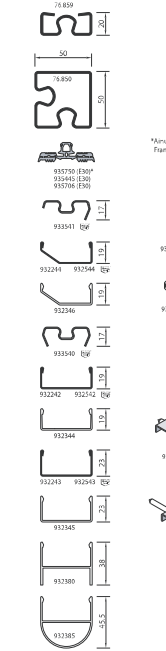
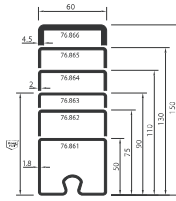
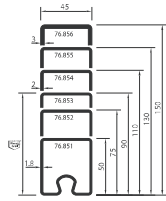

*Alu-Prantsusmaale
France only

938010 - 938015

938006 - 938023

938040 - 938061

938720 - 938731

938735 - 938743

938600

938620 - 938633

938635

938630 - 938633

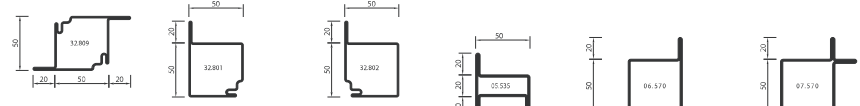
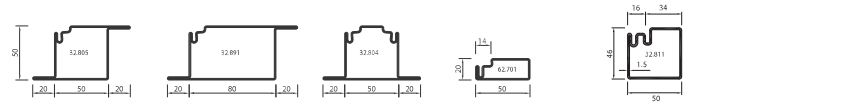
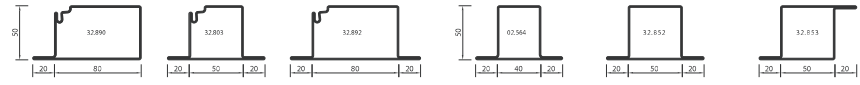
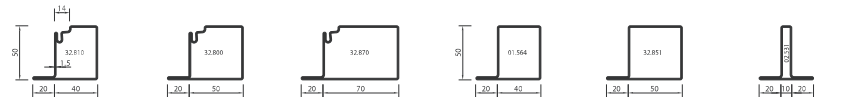

Roostevaba teras
Stainless steel
Edelstahl

Roost Prof 50

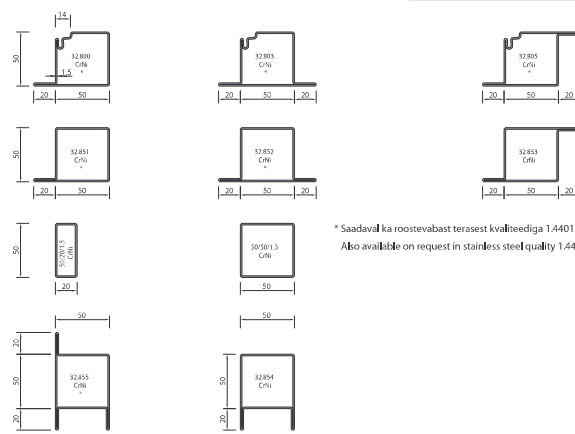

* Saadaval ka roostevabast terasest kvaliteediga 1.4401
Also available on request in stainless steel quality 1.4401

Teras / Alu
Steel / Alu
Stahl / Alu

50

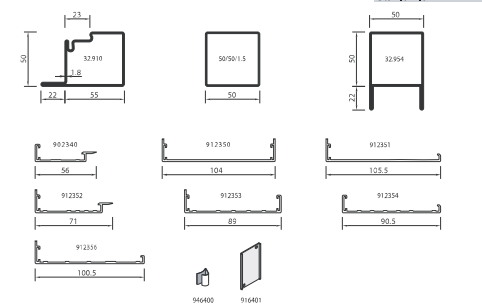

Teras
Steel
Stahl

60

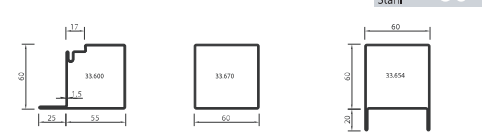

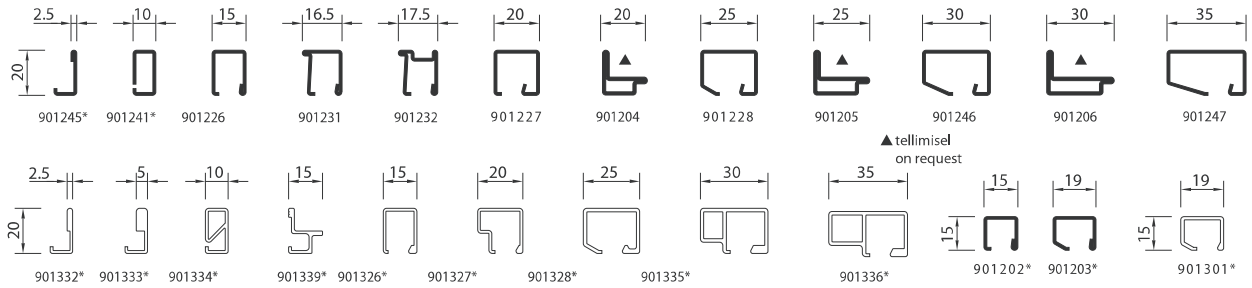

* sertifitseeritud ainult RS-ile (Saksamaa) are certified for RS (Germany) only

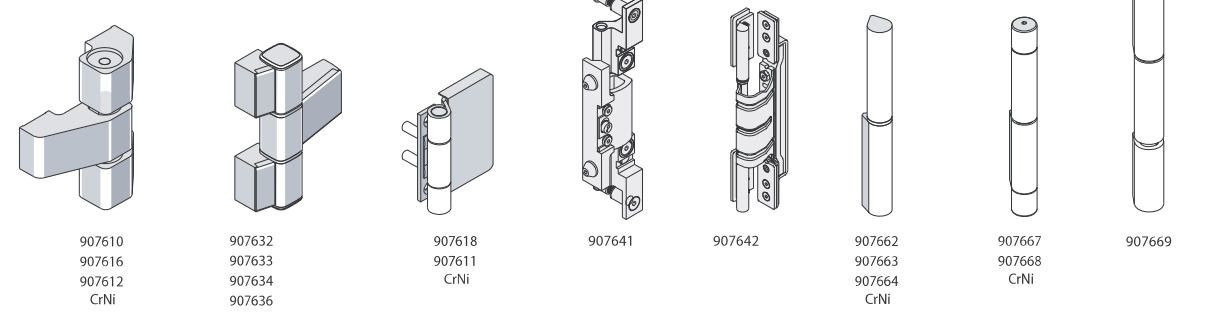
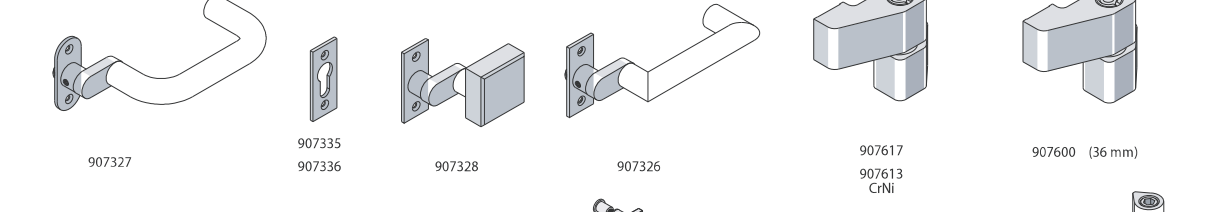
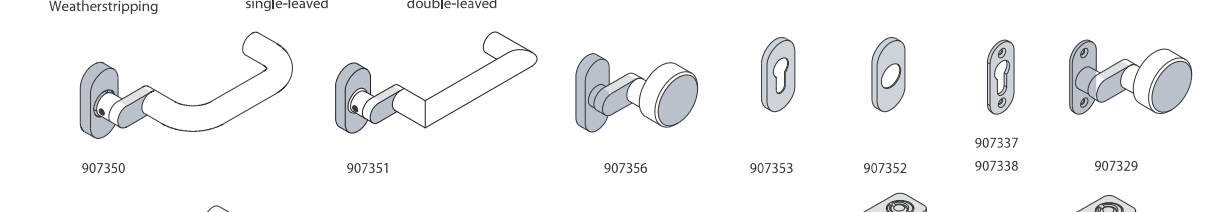
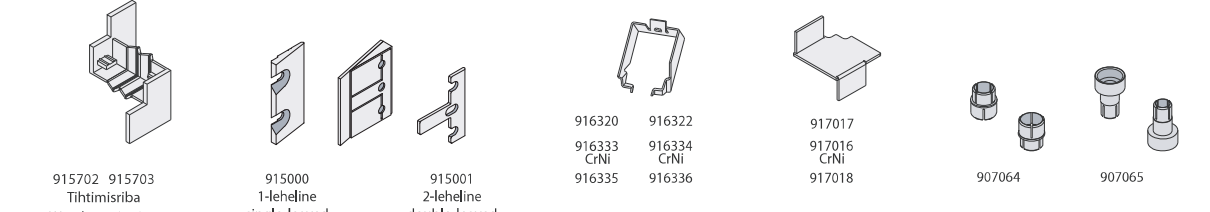
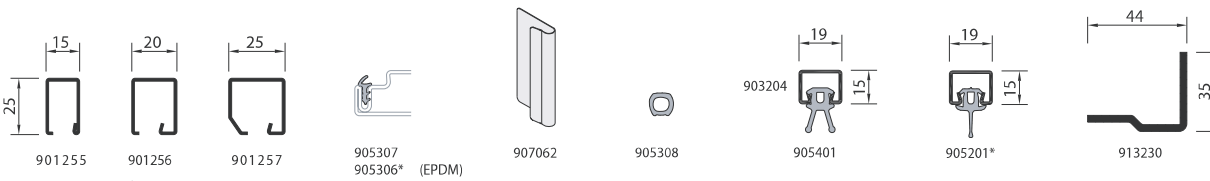
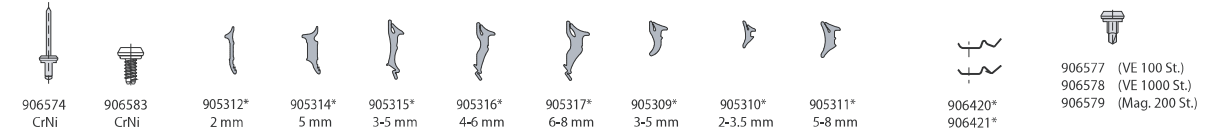
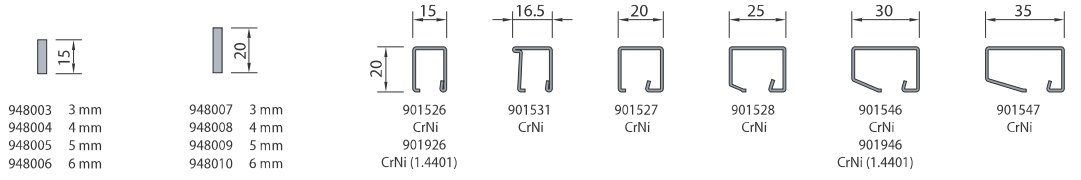

forster fuego® light

Teras
Steel
Stahl

EI30

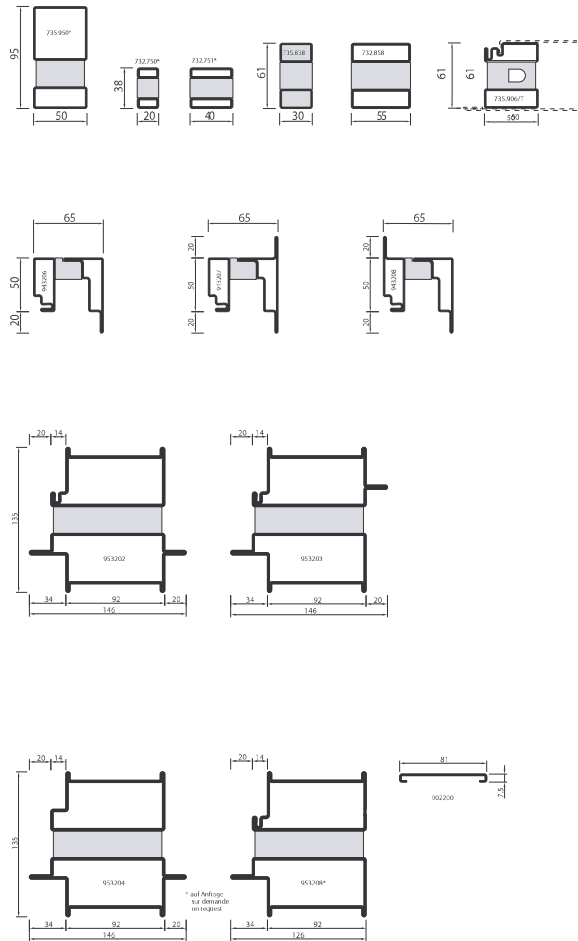
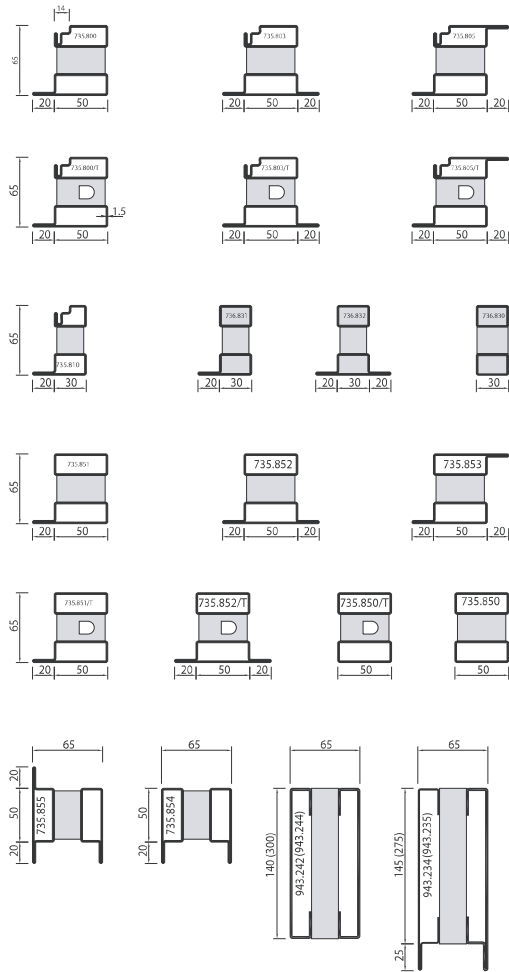

forster fuego® light

Roostevaba teras
Stainless steel
Edelmetall



EI30

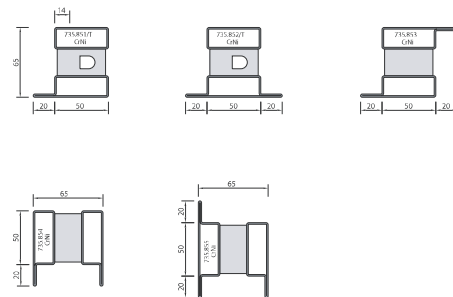
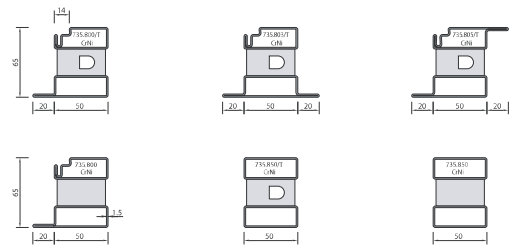

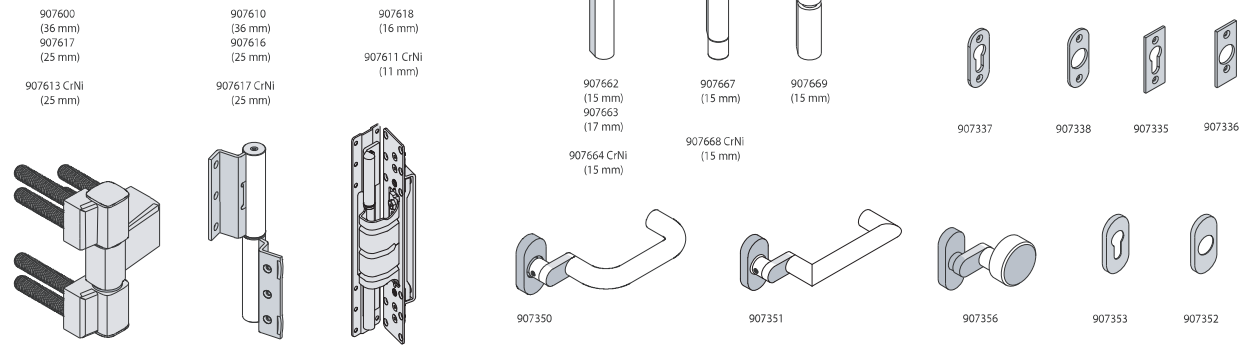
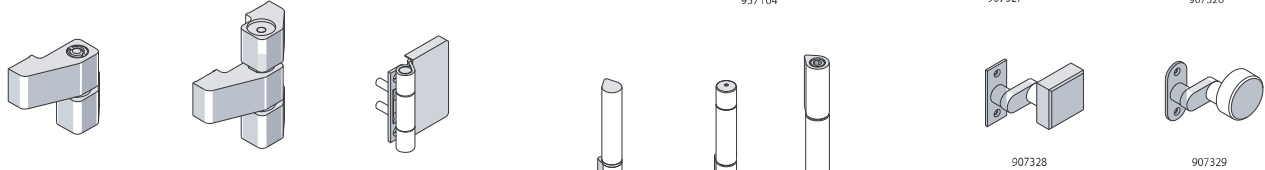
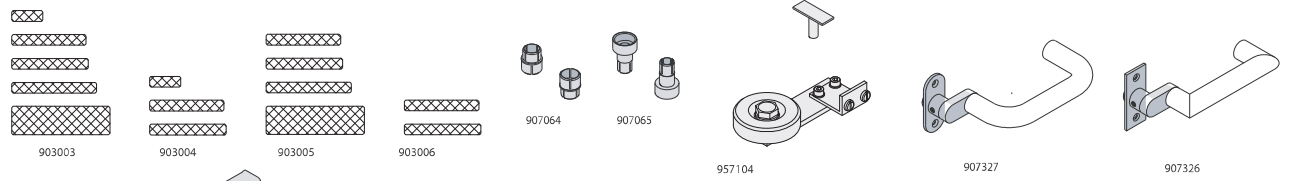
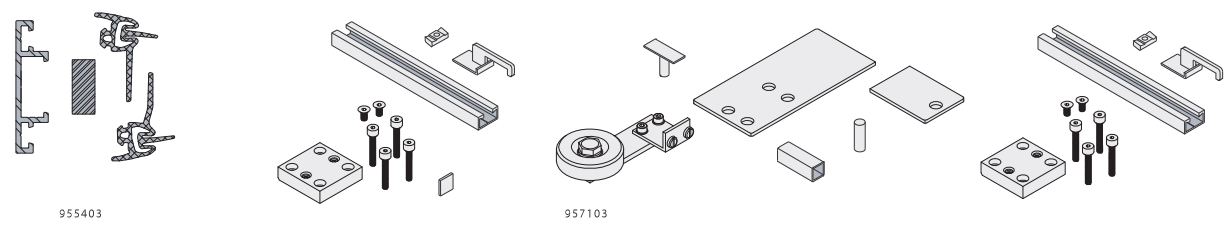
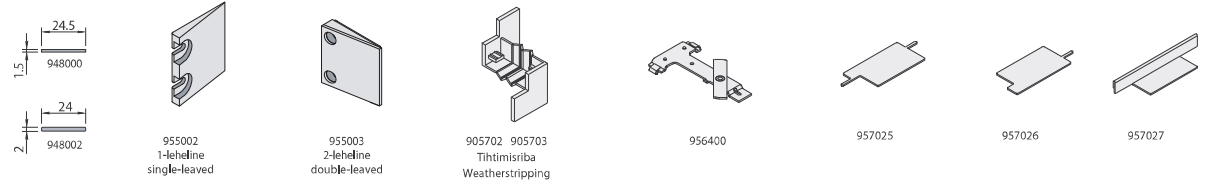
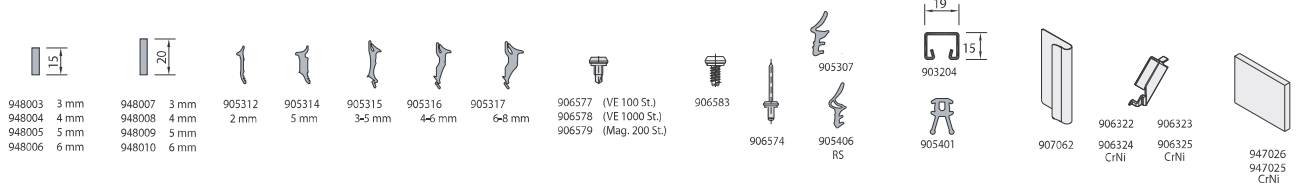
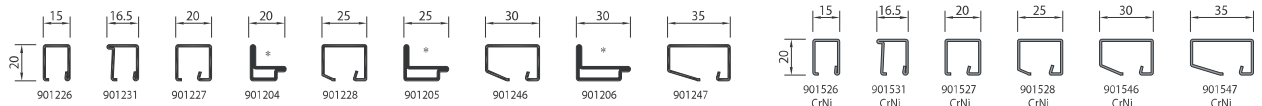

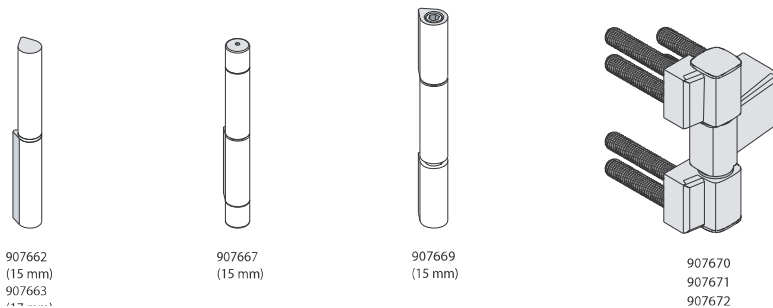
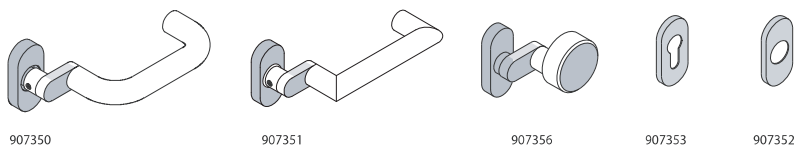
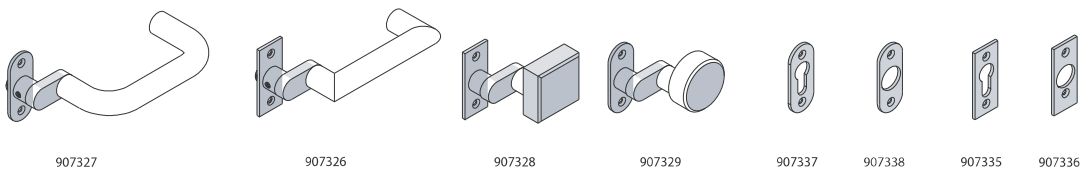
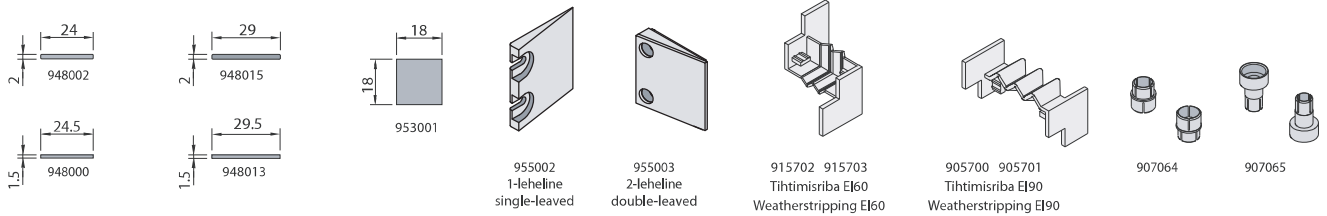
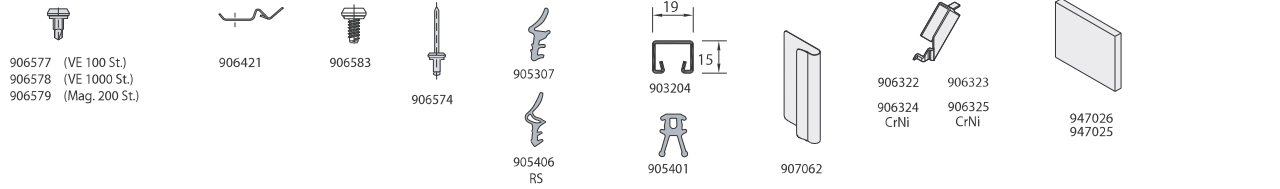
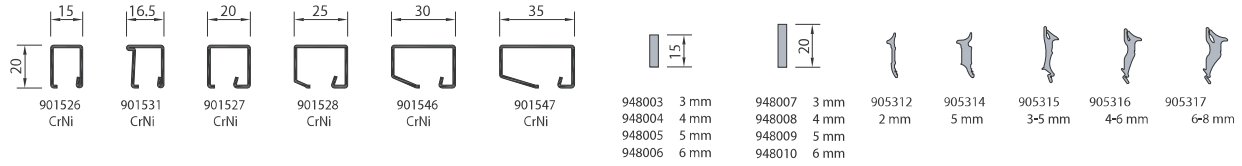
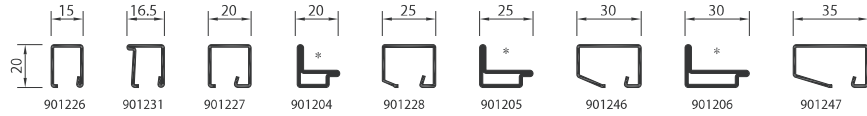

forsterpresto®

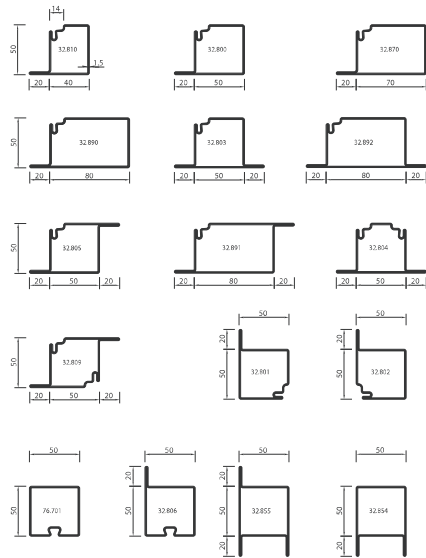

forsterpresto®

Teras
Steel
Stahl

50

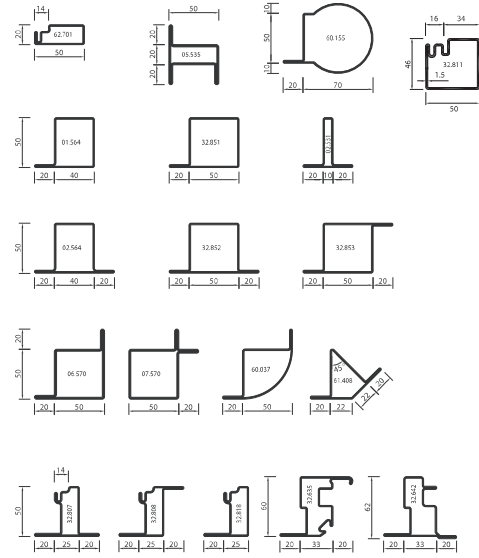

forsterpresto®

Roostevaba teras
Stainless steel
Edelstahl



50

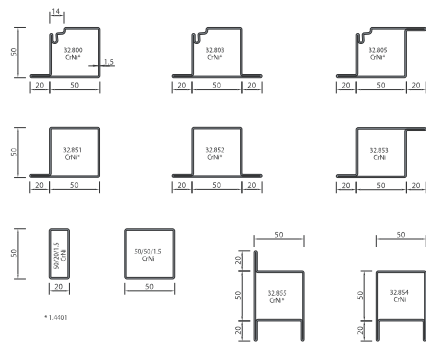

forsterpresto®

Teras / Alu
Steel / Alu
Stahl / Alu

ALU

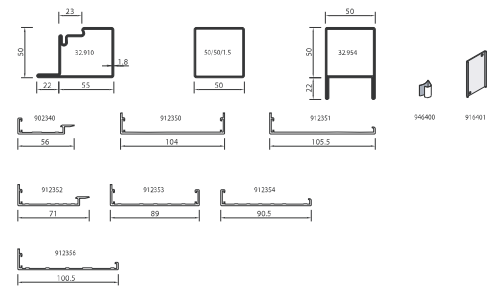

forsterpresto®

Teras
Steel
Stahl

60

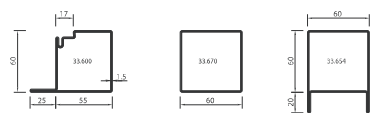

forsterpresto®

Teras
Steel
Stahl

60 S



ILMA KÜLMAKATKESTUSETA UKSED JA AKNAD
DOORS AND WINDOWS WITHOUT THERMAL BREAK

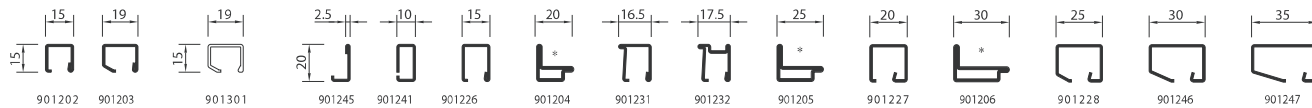

901202 901203 901301

901245 901241 901226 901204 901231 901232 901205 901227 901206 901228 901246 901247

906420
906421

906577 (VE 100 St.)
906578 (VE 1000 St.)
906579 (Mag. 200 St.)

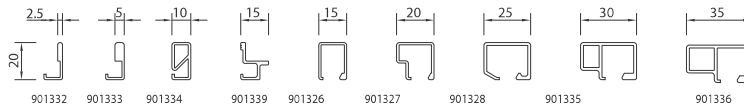

901332 901333 901334 901339 901326 901327 901328 901335 901336

* tellimisel
on request

901526
CrNi
901926
CrNi (1.4401)

901531
CrNi

901527
CrNi

901528
CrNi

901546
CrNi
901946
CrNi (1.4401)

901547
CrNi

906574
CrNi

906583
CrNi

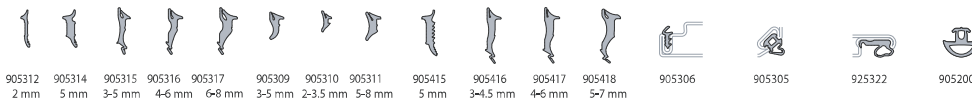

905312 2 mm 905314 5 mm

905315 3-5 mm 905316 4-6 mm 905317 6-8 mm

905309 3-5 mm 905310 2-3.5 mm 905311 5-8 mm

905415 5 mm 905416 3-4.5 mm 905417 4-6 mm 905418 5-7 mm

905306 905305 925322 905200

903204 905201

963301

905900 905904 905902 905905

963302 903200 903201 900100 900103

916320 916322
916333 916334
CrNi CrNi
916335 916336
916303 916304

917017
917016
CrNi
917018

915600 915601

915000
1-leheline
single-leaved

915001
2-leheline
double-leaved

915702
915703

907062

907064 907065

907350

907351

907356

907353 907352

907617
907613
CrNi

907616
907610
907612
CrNi

907632
907633
907634
907636

907618
907611
CrNi

907662
907663
907664
CrNi

907667
907668
CrNi

907669

907641

907642
907643

917644
(DIN parem/right)
917645
(DIN vasak/left)

917646 CrNi
(DIN parem/right)
917647 CrNi
(DIN vasak/left)

907327

907326

907328

907329

907337 907338 907335 907336

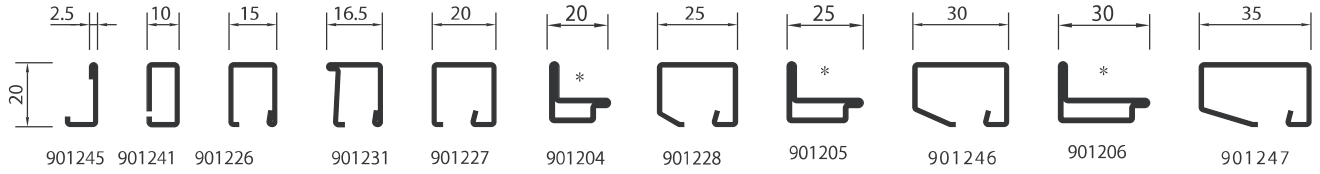
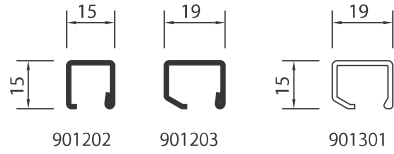

* tellimisel
on request

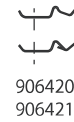
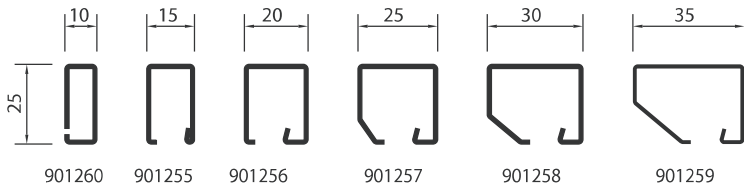
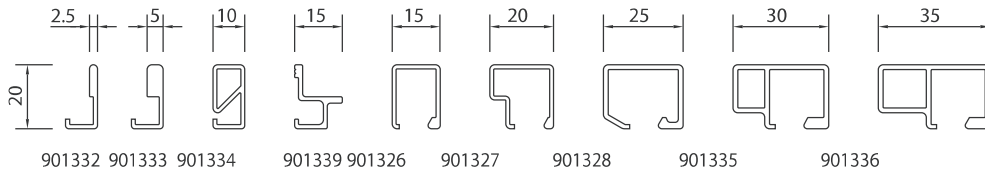

906577 (VE 100 St.)
906578 (VE 1000 St.)
906579 (Mag. 200 St.)

